

LEASEHOLD



Flat - Retirement

36 WOODMERE COURT, 7 AVENUE ROAD, LONDON, N14 4BW

Asking Price

£200,000

FEATURES

- Popular Retirement Development
- Lift Service
- Beautiful Communal Grounds and Gardens
- Residents Parking
- Minimum Age 60 Years
- 2 Bedrooms
- Communal Lounge
- Resident Management Staff



RASH & RASH

2 Bedroom Flat - Retirement located in London

We are pleased to offer for sale this well maintained chain free, 2 bedroom 1st floor retirement apartment in a popular development and close to transport link and amenities. The property has two bedrooms (one is currently used as a dining room), a bathroom, spacious lounge and a fitted kitchen. The property benefits from a communal lounge area and gardens, lift, multiple 24 hour emergency cords and resident staff.

Woodmere Court is a short walk to Southgate High Street and Tube Station but also has a bus stop outside the development. We highly recommend a viewing.

WOODMERE COURT,
AVENUE ROAD, N14
Approx. Gross Internal Area
636 Sq Ft - 59.08 Sq M

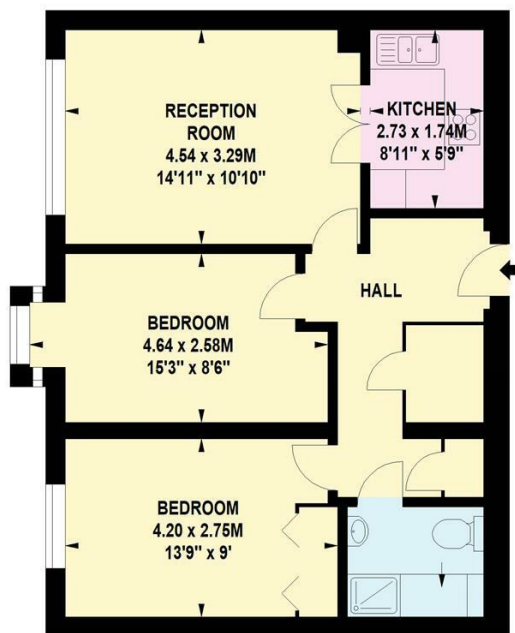
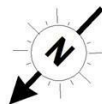

FIRST FLOOR

Call us on

02088822828

info@rashandrash.com

<https://www.rashandrash.com/>

Council Tax Band

E

Energy Efficiency Rating		
	Current	Potential
Very energy efficient - lower running costs		
(92 plus) A		
(81-91) B		
(69-80) C		
(55-68) D		
(39-54) E		
(21-38) F		
(1-20) G		
Not energy efficient - higher running costs		
	79	86
England & Wales		
EU Directive 2002/91/EC		

Agents Note: Whilst every care has been taken to prepare these particulars, they are for guidance purposes only. All measurements are approximate and are for general guidance purposes only and whilst every care has been taken to ensure their accuracy, they should not be relied upon and potential buyers are advised to recheck the measurements.

RASH & RASH